



# User Manual

## Air Circulation Fan

MODEL: FG18-24FP

Please read this manual carefully and keep it for future reference.  
The device is only suitable for well insulated spaces or occasional use.

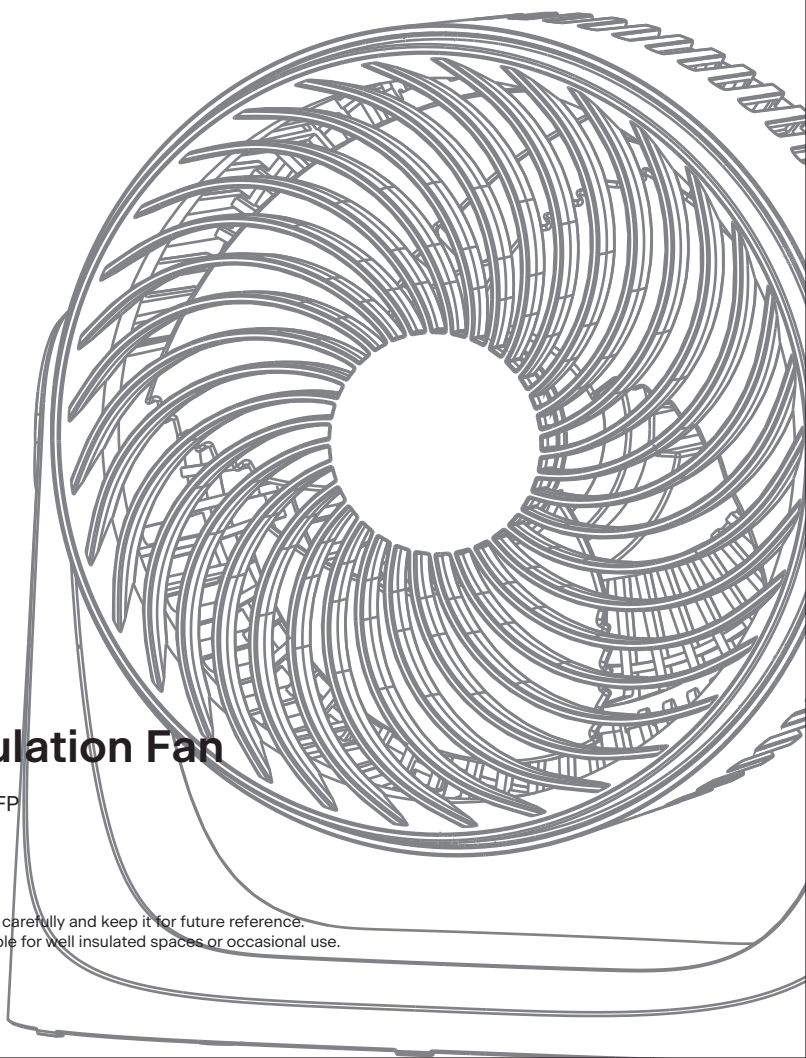



# **Thanks for Choosing PELONIS!**

Your support is pivotal and  
we hope you enjoy it!

# Contents

Important Safeguards .....	01
Product Overview .....	04
Operation Instructions .....	05
Troubleshooting .....	06
Cleaning And Maintenance .....	07
Specifications .....	08
User Servicing Instructions .....	09

# READ AND SAVE THESE INSTRUCTIONS

## Important Safeguards

### CAUTION

1. Read Rules for Safe Operation and Instructions carefully.
2. This appliance is not intended for use by persons (including children) with reduced physical, sensory or mental capabilities, or lack of experience and knowledge, unless they have been given supervision or instruction concerning use of the appliance by a person responsible for their safety. Children should be supervised to ensure that they do not play with the appliance.
3. Keep electrical appliances out of reach from children or infirm persons. Do not let them use the appliances without supervision.
4. Disconnect fan when moving from one location to another.
5. Indoor and household use only.

## **⚠ WARNING**

- 1.** If the supply cord is damaged, it must be replaced by manufacturer or its service agent or a similarly qualified person in order to avoid a hazard.
- 2.** To protect against the risk of electrical shock, do not immerse the unit, cord or plug in water or other liquid.
- 3.** When the appliance is not in use and before cleaning, unplug the appliance from the outlet.
- 4.** **WARNING:** To Reduce The Risk Of Fire Or Electric Shock, Do Not Use This Fan With Any Solid-State Speed Control Device.
- 5.** This product employs overload protection (fuse).  
A blown fuse indicates an overload or short-circuit situation. If the fuse blows, unplug the product from the outlet. Replace the fuse as per the user servicing instructions (follow product marking for proper fuse rating) and check the product. If the replacement fuse blows, a short-circuit may be present and the product should be discarded or returned to an authorized service facility for examination and/or repair.  
Do not operate any fan with a damaged cord or plug.  
Discard fan or return to an authorized service facility for examination and/or repair.

## **⚠ WARNING**

- 6.** Do not run cord under carpeting. Do not cover cord with throw rugs, runners, or similar coverings. Do not route cord under furniture or appliances. Arrange cord away from traffic area and where it will not be tripped over.
- 7.** This appliance has a polarized plug (one blade is wider than the other). To reduce the risk of electric shock, this plug is intended to fit in a polarized outlet only one way. If the plug does not fit fully in the outlet, reverse the plug. If it still does not fit, contact a qualified electrician. Do not attempt to defeat this safety feature.
- 8.** To Reduce The Risk Of Fire, Electric Shock Or Injury To Persons, Do Not Use Replacement Parts That Have Not Been Recommended By The Manufacturer (e.g.Parts Made At Home Using A 3D Printer).

# Product Overview

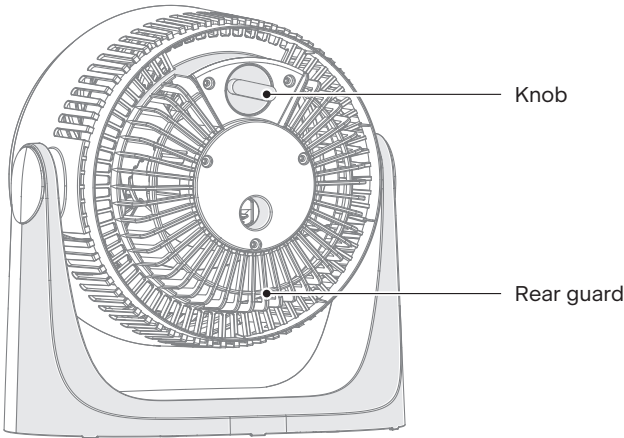
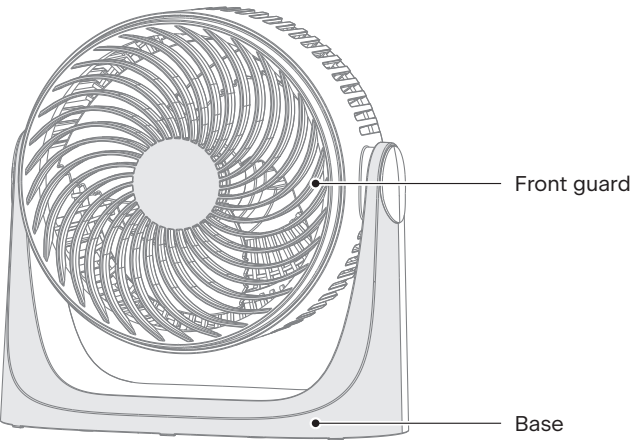

[Note]

All the pictures in this manual are for explanation purpose only. Any discrepancy between the real object and the illustration in the drawing shall be subject to the real subject.  
Remove parts from the component before performing installation.

# Operating Instructions

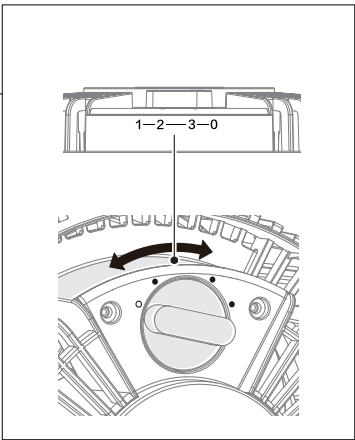
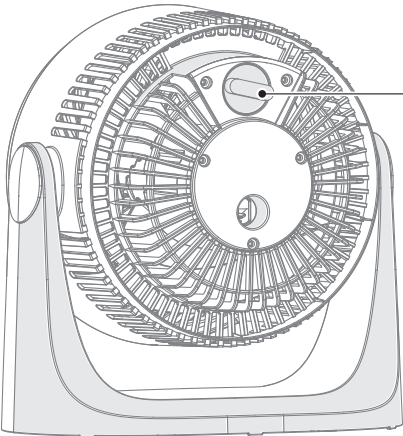

Knob	Function Description
0	Power Off.
1	Low speed.
2	Medium speed.
3	High speed.



# Troubleshooting

Operation of your appliance can lead to errors and malfunctions. The following tables contain possible causes and notes for resolving an error message or malfunction. It is recommended to read the table below carefully in order to save your time and money that may cost for calling to the service center.

Fault Problem	Fault Cause	Fault Solution
The machine does not work properly after power on	The power cable is not plugged in or has poor contact.	Make sure the plug is properly inserted into the socket.
	The switch on the body is not turned on.	Turn on the switch on the body.

# Cleaning And Maintenance

## Precautions

The fan requires minimal maintenance. Do not try to fix it by yourself. Refer it to qualified service personnel if service is needed.

1. Before cleaning and assembling, unplug the fan power.
2. To ensure adequate air circulation to the motor, keep vents at the rear of the motor free of dust. Do not disassemble the fan to remove dust.
3. Please wipe the exterior parts with a soft cloth soaked in mild detergent
4. Do not use any abrasive detergent or solvents to avoid scratching the surface.
5. Do not use any of the following as a cleaner: gasoline, thinner.
6. Do not allow water or any other liquid entering into the motor housing or interior parts.
7. Be sure to unplug from the electrical supply source before cleaning.
8. Plastic parts should be cleaned with a soft cloth moisten with mild soap. Thoroughly remove soapsuds with dry cloth.

# Specifications

Model	Power Supply	Rated Power
FG18-24FP	120V~,60Hz	28W

## User Servicing Instructions

- a) Grasp plug and remove from the receptacle or other outlet device. Do not unplug by pulling on cord.
- b) Open fuse cover. Slide open fuse access cover on top of attachment plug towards blades.(Fig. ①)
- c) Remove fuse carefully. Insert the tip of your tool into fuse slot(close with the terminal), then prize the fuse gradually and slowly, but not overexert. If you feel tight, you can try it at several times and prize the fuse little by little. When one side of the fuse has been prized, then you can get the fuse out entirely.  
(Fig. ②)
- d) Risk of fire. Replace fuse only with 2.5 Amp, 125 Volt fuse.(Fig. ③)
- e) Close fuse cover. Slide closed the fuse access cover on top of attachment plug.(Fig. ④)
- f) Risk of fire. Do not replace attachment plug. Contains a safety device (fuse)that should not be removed. Discard product if the attachment plug is damaged.
- g) When the fan suddenly does not work during normal operation, please check whether it is a problem with the fuse.

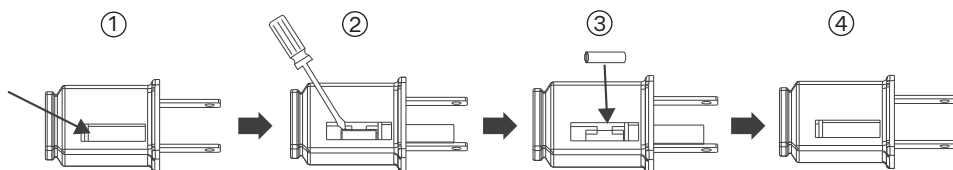

### [Note]

- When you replace the fuse, please don't operate suddenly or overexert, or else the product will be damaged or cause accident.
- When you feel it hard to be operated, please make sure you have got the right way.
- Risk of fire. Do not replace attachment plug. Contains a safety device (fuse) that should not be removed. Discard product if the attachment plug is damaged.







