



User Manual

PTC FAN HEATER

MODEL: PHF15RSAPH30



WARNING NOTICE:

Before using this product, please read this manual carefully and keep it for future reference. For additional support, please call customer service at **1-866-646-4332**.

Before use, please carefully read the user manual.

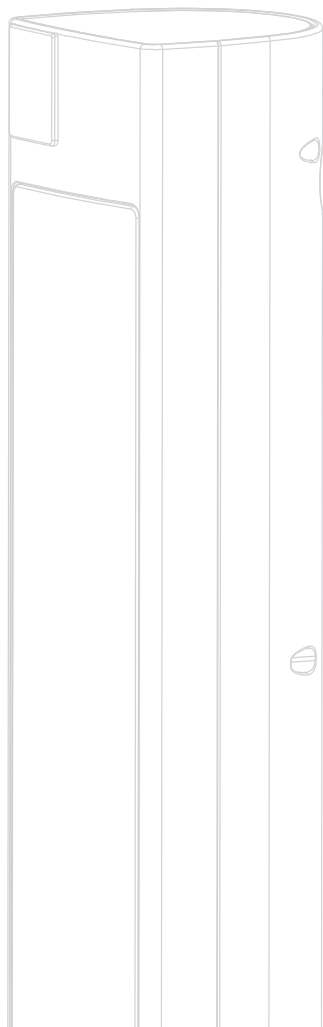



Thanks for Choosing PELONIS!

Your support means the world to us,
we hope you enjoy our product.

Contents

Important Safeguards	01
Product Overview	04
Operation Instructions	05
Troubleshooting	09
Cleaning & Maintenance	09
Specifications	10
Service & Support	11
Warranty	12

Important Safeguards

READ AND SAVE THESE INSTRUCTIONS

CAUTION

PLEASE READ AND SAVE THESE IMPORTANT SAFETY INSTRUCTIONS

When using electrical appliances, basic precautions should always be followed to reduce the risk of fire, electric shock, and injury to persons, and hyperthermia including the following:

1. Read all instructions before using heater.
2. This heater is hot when in use. To avoid burns, do not let bare skin touch hot surfaces. If provided, use handles when moving this heater. Keep combustible materials, such as furniture, pillows, bedding, papers, clothes, and curtains at least 3 feet (0.9m) from the front of the heater and keep them away from the sides and rear.
3. Extreme caution is necessary when any heater is used by or near children or invalids and whenever the heater is left operating and unattended.
4. Always unplug heater when not in use.
5. Do not operate any heater with a damaged cord or plug or after the heater malfunctions, has been dropped or damaged in any manner. Discard heater, or return to authorized service facility for examination and/or repair.
6. Do not use outdoors.
7. This heater is not intended for use in bathrooms, laundry areas and similar indoor locations. Never locate heater where it may fall into a bathtub or other water container.
8. Do not run cord under carpeting. Do not cover cord with throw rugs, runners, or similar coverings. Do not route cord under furniture or appliances. Arrange cord away from traffic area and where it will not be tripped over.
9. CAUTION: This unit has a polarized plug (one blade is wider than the other). To reduce the risk of shock, this plug is intended to fit only one way in a polarized outlet. If the plug does not fit fully in the outlet, reverse the plug. If it still does not fit, contact a qualified electrician. DO NOT attempt to defeat this safety feature. To do so could result in an electric shock hazard.

10. This heater draws 12.5 amps during operation. To prevent overloading a circuit, do not plug the heater into a circuit that already has other appliances or other electronics working.
11. **CAUTION:** It is normal for the plug to feel warm to the touch; however, a loose fit between the AC outlet (receptacle) and plug may cause overheating and distortion of the plug. Contact a qualified electrician to replace loose or worn outlet.
12. To disconnect heater, turn controls to off, then remove plug from outlet. Never pull by the cord.
13. Do not insert or allow foreign objects to enter any ventilation or exhaust opening as this may cause an electric shock or fire, or damage the heater.
14. To prevent a possible fire, do not block air intakes or exhaust in any manner. Do not use on soft surfaces, like a bed, where openings may become blocked.
15. A heater has hot and arcing or sparking parts inside. Do not use it in the areas where gasoline, paint, or flammable liquids are used or stored.
16. Use this heater only as described in this manual. Any other use not recommended by the manufacturer may cause fire, electric shock, or injury to persons.
17. **CAUTION:** Always plug heaters directly into a wall outlet/receptacle. Never use with an extension cord or reloadable power tap (outlet/power strip).
18. The output of this heater may vary and its temperature may become intense enough to burn exposed skin. Use of this heater is not recommended for persons with reduced sensitivity to heat or an inability to react to avoid burns.
19. **CAUTION:** To prevent electric shock, match wide blade of plug to wide slot and fully insert.
20. This heater may include an audible (a visual) alarm to warn that parts of the heater are getting excessively hot. If the alarm sounds (flashes), immediately turn the heater off and inspect for any objects on or adjacent to the heater that may cause high temperatures. **DO NOT OPERATE THE HEATER WITH THE ALARM SOUNDING (FLASHING).**
21. Hyperthermia can result in death. Symptoms of hyperthermia include high body temperature, headache, nausea, vomiting, tiredness, dizziness, fainting, and rapid pulse. If symptoms related to hyperthermia is present, turn off the heater and seek medical attention.

- 22.** To avoid excessive room temperatures which can cause hyperthermia:
DO NOT leave product running unattended in a confined space around infants, or individuals with reduced physical, sensory, or mental capabilities.

SAVE THESE INSTRUCTIONS

Product Overview

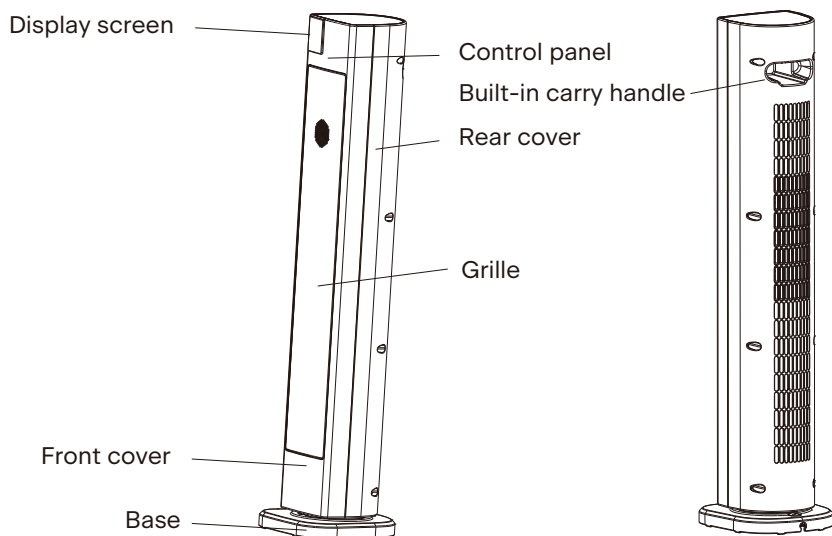

Accessories



Remote Control x 1



Battery x 2

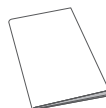

User Manual x 1

[Note]

All the pictures in this manual are for explanation purpose only. Any discrepancy between the actual product and the illustration in the drawing shall be subject to the actual product.

Operating Instructions

Control Panel

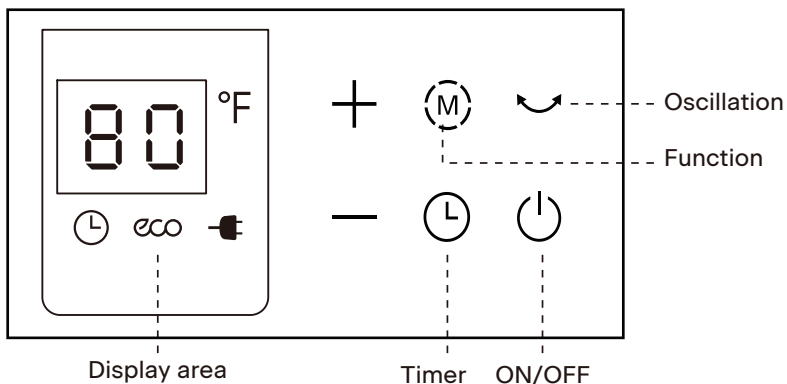

Check before turning on the unit

- Check if the power cord is under good condition.
- The product adopts 120V AC power supply, before use, please confirm if the rated current of the power socket meets the local requirements with safe grounding device, otherwise, please replace it with the qualified socket.

Start the unit

- Plug the unit into a grounded 120V outlet, the power light "☑" on , it means the heater is energized. Press the ON/OFF key (or press the ON/OFF key of the remote controller) for start, the machine supplies air at high power after start, the digital screen displays "HI".

Function setting

- Repeatedly press the "Function" key so that the heater switches in the order of "high- low - ECO mode - fan - high".

Temperature setting

- In the ECO mode of the machine, press "+" or "-" can set the temperature value, set the range of 41-95°F. When the room temperature exceeds the set temperature at 4°F, the unit will stop working, and stay in the standby state. When the temperature is lower than the set temperature, the unit starts to heat up again.

Timing function

Timing stop

- When the heater is turned on, press the TIMER key to enter the timing stop state (within 0-12 hours), then press the "+" key to increase the timing stop time, and press the "-" key to decrease the timing stop time.

Forced shutdown function

- If the unit keeps running for 24 hours without any operation, it will automatically shut down.

Oscillation function

- The electric heater in operation mode, press the "Oscillation" key to open the oscillation function, pressing this button to turn off the oscillation function; when the electric heater stops heating function, the wind oscillating function also stop.

Temperature sensor short circuit, open circuit protection function

- No matter in what mode, the temperature sensor appears short circuit or open circuit, digital screen displays "E1" or "E2" and constantly flicker, while any key operation is invalid and the buzzer rings 10 times.

Safety protection

- In the start state, when the room temperature TH is above 122°F, close all outputs system, The digital screen displays "FF" and flashes 1 time per second at a frequency of 75 times, press any key will not work, only the power down to exit the protection.

Tip-over switch

- As a safety measure, the unit will shut off automatically if it is knocked over. Should this occur, simply turn the heater off and stand it back up to a regular upright position, then switch it back on.

ECO energy saving function

- Select the ECO energy saving gear and set the temperature. The heater will adjust its heating gear by comparison between the ambient temperature and set temperature.

Remote controller

- Use of the remote controller: the key functions are basically the same as the body operation panel.

Remote Control

- Point the remote at the heater's receptor and press the desired control button.
DISPOSAL NOTE: Remove and safely dispose of the batteries before discarding the remote.

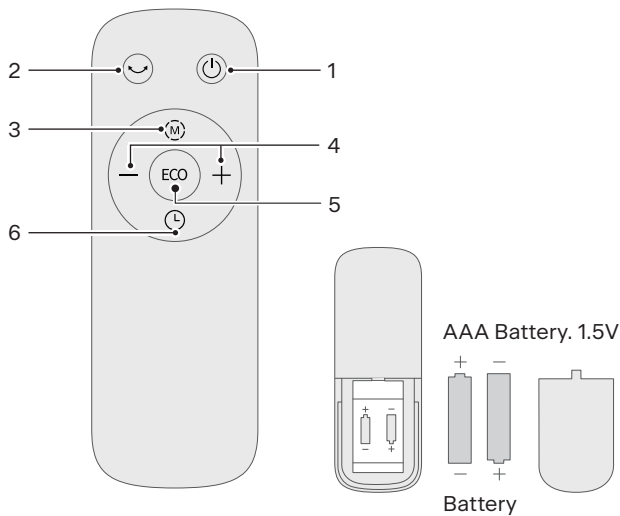

No	Button	Function Description
1		• "ON/OFF" button to power on and off the heater.
2		• Once heater is running, press this button to activate oscillation mode.
3		• Press the "Function" key so that the heater switches in the order of "High Heater Setting -Low Heater Setting - ECO Heater mode - Fan mode.
4		• In ECO Mode, Press "+,-" to set the heating temperature.

No	Button	Function Description
5		<ul style="list-style-type: none"> Press this timer button repeatedly to set the time for air delivery. Increase in increments up to "1-2-3-4-5-6-7-12" hours.
6	ECO	<ul style="list-style-type: none"> ECO Mode

Batteries Installation

1. Slide the battery compartment cover.
2. Insert the batteries, and make sure that the batteries are placed as shown in the Fig 5.
3. Slide back the battery cover shown in the Fig 6.

[Note]

- Use manganese or alkaline batteries of type "AAA". DO NOT use rechargeable batteries.
- Do not dispose of batteries in fire, batteries may explode or leak.
- Do not mix old and new batteries.
- Do not mix alkaline, standard (carbon-zinc) or rechargeable (nickel-cadmium) batteries.

Figure 5

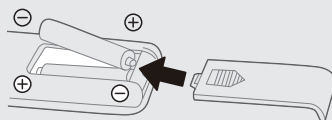
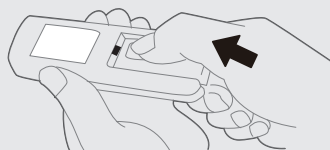

Figure 6



Troubleshooting

If the product does not operate or does not operate properly, first check according to the following list. If the reason the product does not operate or does not operate properly is not included in the following list, the product may have failed. At this time, it is recommended to send the product to the dealer for repair.

Problem	Cause	Solution
Heater plugged in but NOT powering ON.	• Plug improperly inserted into power outlet.	Check that the power plug is fully and properly inserted into the power outlet, and re-insert if needed.
The heater suddenly shuts-off during heating.	• The temperature exceeds the threshold of the thermal cut-off.	Unplug the heater, allow to cool, and then resume normal operation.

Cleaning And Maintenance

It is recommended that the heater be cleaned at least one time during the operating season in order to provide the optimum level of performance. ALWAYS TURN THE POWER SWITCH OFF AND UNPLUG THE HEATER BEFORE CLEANING. Be sure to save the original packaging for off-season storage.

- Turn the heater “OFF”, unplug it and wait for the heater to cool down.
- Use a dry cloth only to clean external surfaces of the heater.
- Do not use any cleaning agents or detergents.
- Never immerse the heater in water.
- Store the heater inside the original packaging and place in a dry and cool location.
- Any other maintenance shall be performed by an authorized representative.

Warning: This heater cannot achieve accurate temperature control of the environment and thus, cannot be used as a temperature control device for storage locations, items, animals, plants, or other environments.

Specifications

Model

PHF15RSAPH30

Voltage

120V~, 60Hz

Rated power

1500 W

SERVICE AND SUPPORT

In the event of a warranty claim or if service is required for this product, please contact us at the following:

Toll Free: 1-866-646-4332

For questions or comments, please write to:

Midea America Corp.

300 Kimball Drive,
Parsippany NJ 07054

For your records, staple your sales receipt to this manual and record the following:

DATE OF PURCHASE: _____

PLACE OF PURCHASE: _____

(STAPLE SALES RECEIPT HERE)

**NOTE: PROOF OF PURCHASE IS REQUIRED FOR ALL
WARRANTY CLAIMS**

PRINTED IN VIETNAM

1 YEAR LIMITED WARRANTY

Please read all the instructions before attempting to use this product.

Midea America Corp. warrants as limited herein to the original purchaser of retail that each new Heater, shall be free of defects in material and workmanship for a period of one (1) year from the date of delivery. This one (1) year warranty is limited to the Motor and Electric Element. The date of delivery establishes the warranty period, should service be required.

In the event of malfunctions or failure of your Heater, simply deliver or send the Heater, postage prepaid along with PROOF OF PURCHASE, within the warranty of one(1) year, to Midea America Corp.. Midea America Corp. reserves the right to inspect the claimed defective part or parts to determine if the defect or malfunction complaint is covered by this warranty. Midea America Corp. shall, within sixty (60) days after receipt of the product, at its option, repair and/or replace the defective part or parts free of charge. This warranty shall only cover defects arising from normal usage. Midea America Corp. assumes no responsibility whatsoever if the Heater should fail during the warranty period by reason of:

- Misuse, negligence, physical damage or accidents.
- Lack of maintenance (see instructions for proper maintenance).
- Repair by any unauthorized party during the warranty period.
- Damage caused by connection to an improper input voltage (see specification label on your Heater).

Midea America Corp. makes no further warranties or representations, express or implied except those contained herein. No representative or dealer is authorized to assume any other liability regarding the Heater. The duration of the implied warranty granted under State law, including warranties of merchantability and fitness for particular purpose are limited in duration should the duration of the express warranty grant it hereunder. Midea America Corp. shall in no event be liable for direct, indirect, special or consequential damages.

Some states do not allow limitations on how long an implied warranty lasts, and/or the above limitations or exclusion may not apply to you. This warranty gives you specific legal rights and you may have other rights which vary from state to state.

