

PELONIS

en

USER MANUAL

PEDESTAL FAN PFS40M2ABB

Rated voltage: 120V
Rated power: 32W
Frequency: 60Hz

Warning Notice: Before using this product, please read this manual carefully and keep it for future reference. For additional support, please call customer service at 866-646-4332.

The design and specifications are subject to change without prior notice for product improvement. Consult with your dealer or the manufacturer for details.



PFS40M2ABB

pelonis.com

SAFETY PRECAUTIONS	3
IMPORTANT INSTRUCTIONS	3
RULES FOR SAFE OPERATION	4
PART NAMES	5
ASSEMBLY OF STAND & EXTENSION POLE	6
FRONT AND REAR GRILLE INSTALLATION	7
OPERATING INSTRUCTIONS	7
USER SERVICING INSTRUCTIONS	8
CLEANING	8
SERVICE AND SUPPORT	9
1 YEAR LIMITED WARRANTY	10

Read This Manual

Inside you'll find many helpful hints on how to use and maintain your appliance properly. Just a little preventive care on your part can save you a great deal of time and money over the life of your appliance. You'll find many answers to common problems in the troubleshooting tips - you should be able to fix most of them quickly before calling service. These instructions may not cover every possible condition of use, so common sense and attention to safety is required when installing, operating and maintaining this product.



CAUTION

- For support, please call the Service Center at 1-866-646-4332.
- This appliance is not intended for use by people (including children) with reduced physical, sensory, or mental capabilities or lack of experience and knowledge, unless they have been given supervision or instruction concerning use of the appliance by a person responsible for their safety.
- Children should be supervised to ensure that they do not play with the appliance.
- The appliance should be installed in accordance with national wiring regulations.

SAFETY PRECAUTIONS

To prevent injury to the user or other people and property damage, the instructions shown here must be followed. Incorrect operation due to ignoring of instructions may cause harm or damage. The level of risk is shown by the following indications.

WARNING

This symbol indicates a hazardous situation which, if not avoided, could result in death or serious injury.

CAUTION

This symbol indicates a hazardous situation, which, if not avoided, could result in minor or moderate injury.

NOTICE

This symbol addresses practices not related to physical injury.

IMPORTANT INSTRUCTIONS

CAUTION

Read Rules for Safe Operation and Instructions Carefully.

WARNING

1. This appliance has a polarized plug (one blade is wider than the other). To reduce the risk of electric shock, this plug is intended to fit in a polarized outlet only one way. If the plug does not fit fully in the outlet, reverse the plug. If it still does not fit, contact a qualified electrician. Do not attempt to defeat this safety feature.
2. **WARNING**—To reduce the risk of fire or electric shock, do not use this fan with any solid-state speed control device.
3. This product employs overload protection (fuse). A blown fuse indicates an overload or short-circuit situation. If the fuse blows, unplug the product from the outlet. Replace the fuse as per the user servicing instructions (follow product marking for proper fuse rating) and check the product. If the replacement fuse blows, a short-circuit may be present and the product should be discarded or returned to an authorized service facility for examination and/or repair.
4. Do not operate any fan with a damaged cord or plug. Discard fan or return to an authorized service facility for examination and/or repair.

WARNING

5. Do not run cord under carpeting. Do not cover cord with throw rugs, runners, or similar coverings. Do not route cord under furniture or appliances. Arrange cord away from traffic area and where it will not be tripped over.
6. Do not leave the fan running unattended.
7. Keep electrical appliances out of reach from children or infirm persons. Do not let them use the appliances without supervision.
8. If the supply cord is damaged, it must be replaced by manufacturer or its service agent or a similarly qualified person in order to avoid a hazard.
9. This appliance is not intended for use by persons (including children) with reduced physical, sensory or mental capabilities, or lack of experience and knowledge, unless they have been given supervision or instruction concerning use of the appliance by a person responsible for their safety. Children should be supervised to ensure that they do not play with the appliance.
10. Once the fan is assembled, the rotor blade guard shall not be taken off anymore.
 - Prior to cleaning, unplug the fan.
 - The rotor guard shall not be disassembled/opened to clean the rotor blades.
 - Wipe the fan enclosure and rotor blade guard with a slightly damp cloth.

SAVE THESE INSTRUCTIONS

RULES FOR SAFE OPERATION

1. Never insert fingers, pencils, or any other object through the grille when fan is running.
2. Disconnect fan when moving from one location to another.
3. Be sure fan is on a stable surface when operating to avoid overturning.
4. DO NOT use fan in window, rain may create electrical hazard.
5. Household use only.

PART NAMES

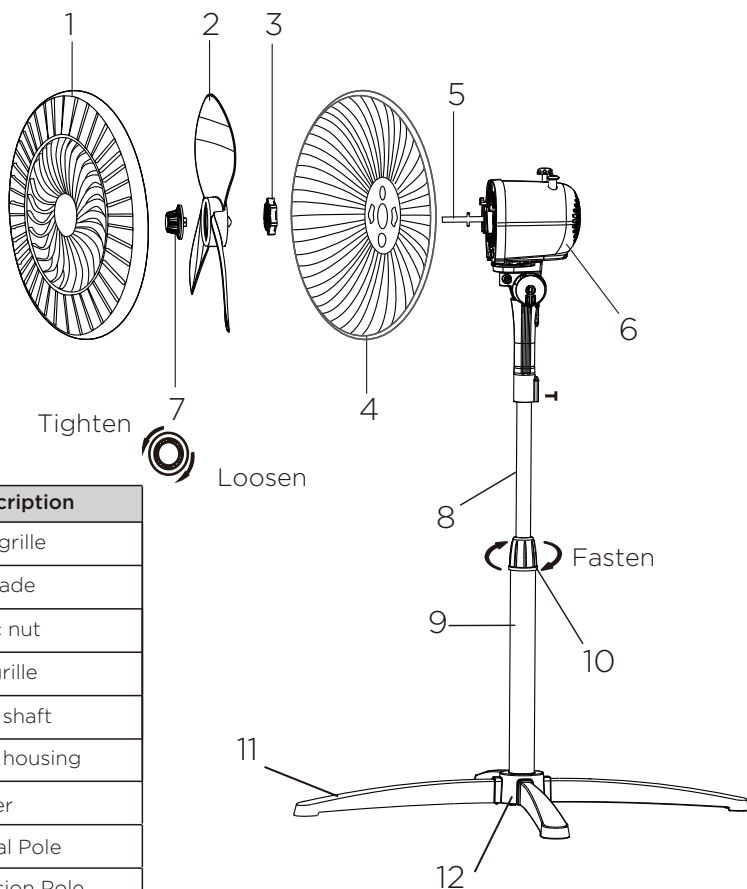

NO.	Description
1	Front grille
2	Fan blade
3	Plastic nut
4	Rear grille
5	Motor shaft
6	Motor housing
7	Spinner
8	Internal Pole
9	Extension Pole
10	Height adjustment ring
11	Stand
12	Cross base connector

NOTICE:

All the pictures in this manual are for explanation purpose only. Any discrepancy between the real object and the illustration in the drawing shall be subject to the real subject.

ASSEMBLY OF STAND & EXTENSION POLE

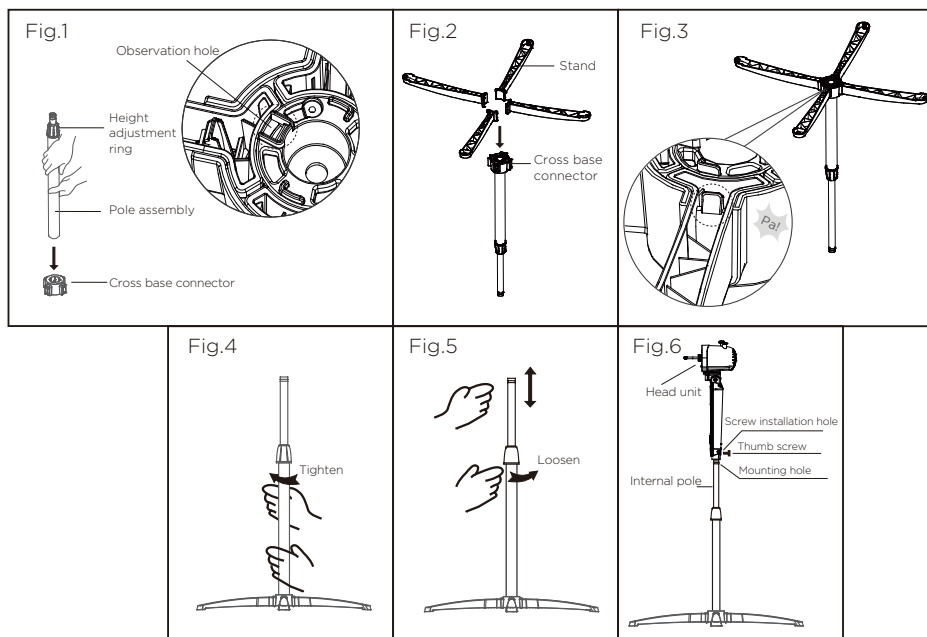

1. Insert the pole assembly into the cross base connector from top to bottom, ensure it is installed in place (use the observation hole to determine if the pole assembly is fully inserted into the cross base connector).(Fig.1)
2. Insert 4 stands into the cross base connector. Ensure the stands are well fixed into the cross base connector.(Fig.2,3)
3. From the extension pole, loosen the height adjustment ring and adjust the internal pole to the desired height. (Note: If you can't find the internal pole, it slides inside the extension pole. You can pull it out from the extension pole.) Fasten the height adjustment ring.(Fig.4,5)
4. To attach the head unit to the internal pole, loosen the thumb screw (separate screw driver needed) on the bottom of the head unit. Place the head unit on the internal pole and tighten the thumb screw in alignment with the groove and mounting hole on the internal pole. (Fig.6)

FRONT AND REAR GRILLE INSTALLATION

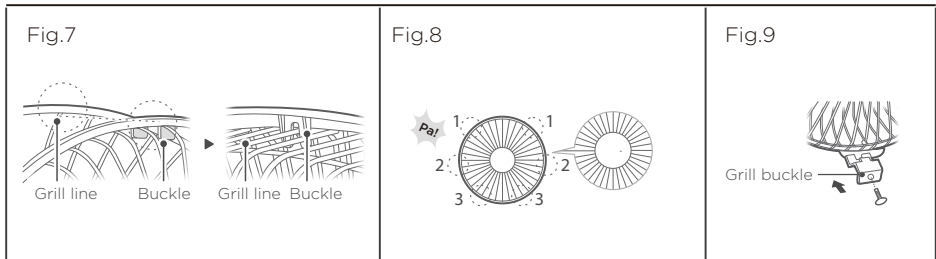

1. Align the front grille buckle with the top line of the rear grille from top to bottom, after aligning, the grilles should look like the corresponding schematic.(Fig.7)
2. Press the grilles with both hands in sequence, and while the grilles are being connected, you will hear several clicks.(Fig.8)
3. For self-locking installation, tighten the screw (separate screw driver needed) on the lower grille buckle of the front grille.(Fig.9)

OPERATING INSTRUCTIONS

1. Speed is controlled by the rotary knob located on top of the motor housing:
0---Off 1---Low 2---Medium 3---High
2. To start/stop the fan head oscillation, push down/pull up the clutch knob that is located on the top of the motor housing.
3. To adjust the air flow upward or downward, push the grilles lightly to the desired direction.
4. The height of the fan can be adjusted by loosening the height adjustment ring, carefully raising or lowering the fan and firmly re-tightening the height adjustment ring.

USER SERVICING INSTRUCTIONS

1. Grasp plug and remove from the receptacle or other outlet device. Do not unplug by pulling on cord.
2. Open fuse cover. Slide open fuse access cover, that is on top of the plug, towards blades.
3. Remove fuse carefully. Insert the tip of your tool into fuse slot (close with the terminal), then pry the fuse gradually and slowly, but not overexert. If it feels tight, you can try to pry the fuse little by little. When one side of the fuse has been pried, then you can get the fuse out entirely.
4. Risk of fire. Replace fuse only with 2.5 Amp, 125 Volt fuse.
5. Close fuse cover. Slide the fuse access cover back to the closed position.
6. Risk of fire. Do not replace attachment plug. Contains a safety device (fuse) that should not be removed. Discard product if the attachment plug is damaged.

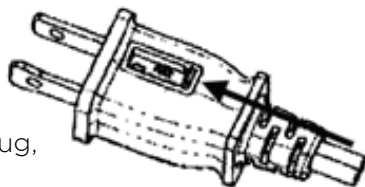

NOTICE:

1. When you replace the fuse, please operate cautiously to avoid accidental damage.
2. If it is hard to place the new fuse, ensure that the fuse is in the correct orientation.

CLEANING

1. Be sure to unplug from the electrical supply source before cleaning.
2. Plastic parts should be cleaned with mild soap and a damp cloth or sponge. Thoroughly remove soap film with clean water on a cloth or sponge.
3. Ensure that water or other liquid does not enter inside of the motor.

SERVICE AND SUPPORT

In the event of a warranty claim or if service is required for this product, please contact us at the following:

Toll Free: 1-866-646-4332

Email us at: customerservice@supportuscenter.com

Midea America Corp.
Parsippany, NJ 07054

For your records, staple your sales receipt to this manual and record the following:

DATE OF PURCHASE: _____

PLACE OF PURCHASE: _____

(STAPLE SALES RECEIPT HERE)

**NOTE: PROOF OF PURCHASE IS REQUIRED FOR ALL
WARRANTY CLAIMS**

PRINTED IN CHINA

1 YEAR LIMITED WARRANTY

This is the only express warranty for this product and is in lieu of any other warranty or condition.

This product is warranted to be free from defects in material and workmanship for a period of one (1) year from the date of original purchase. During this period, your exclusive remedy is repair or replacement of this product or any component found to be defective, at our option; however, you are responsible for all costs associated with returning the product to us and our returning the product or component under this warranty to you. If the product or component is no longer available, we will replace with a similar one of equal or greater value.

This warranty does not cover wear from normal use, and operation doesn't conformity with the instruction manuals, or damages to the product resulting from accident, alteration, abuse, or misuse. This warranty extends only to the original consumer purchaser or gift recipient. Keep the original sales receipt, as proof of purchase is required to make a warranty claim. This warranty is void if products is used for other than single-family household use or subjected to any voltage and waveform other than as specified on the label.

We exclude all claims for special, incidental, and consequential damages by breach of express or implied warranty. All liability is limited to amount of the purchase price. Every implied warranty, including any statutory warranty or condition of merchant-ability or fitness for particular purpose, is disclaimed except to the extent prohibited by law, in which case such warranty or condition is limited to the duration of this written warranty.

This warranty gives you specific legal rights. You may have other legal rights that vary depending on where you live. Some states or provinces do not allow limitations on implied warranties or special, incidental consequential damages, so the foregoing limitations may not apply to you.

Please note that failure to complete and submit this form does not diminish your warranty rights.

Customer Service:
Midea America Corp.
Parsippany, NJ 07054

PELONIS